

The University of Tokyo (Graduate Schools) Examination Fee Payment by Credit Card, Union Pay, and Alipay

24 hours a day, 365 days a year, you can pay anytime! Easy, Convenient and Simple!

You can pay the Examination Fee by using
Credit Card, Union Pay, and Alipay.



Access

<https://e-shiharai.net/english/>



You can access
from our
website too!

Web Application - Online Transaction

- | | |
|--|--|
| 1. Top Page | Click "Examination Fee". |
| 2. Terms of Use and Personal Information Management | Please read the Terms of use and Personal Information Management.
Click "Agree" button located in the lower part of this page if you agree with these terms.
Click "Not agree" button located in lower part of this page if you do not agree with these terms. |
| 3. School Selection | Select the name of the Educational Institution. |
| 4. School Information | Read the information carefully and click "Next". |
| 5. Category Selection | Choose First to Fourth Selection and add to Basket. |
| 6. Basket Contents | Check the contents and if it is OK, click "Next". |
| 7. Basic Information | Input the applicant's basic information.
Choose your credit card and click "Next". |

Paying with Credit Card

Input Credit Card Number (15 or 16-digits),
expiration date and security code.

All of your application information is displayed.
Click "Confirm" to verify.

Click "Print this page" button and print out
"Result" page.

Paying with Union Pay, Alipay

Follow the onscreen instructions to complete the card payment.

Please click the "Application Results" button in the upper
part of this site (e-shiharai.net).

Please write down the "Receipt Number" given when you
complete your application, and enter your
"Payment Method", "Receipt Number" and "Birth Date".
Please make sure your printer is ready.

Please print out the "Payment Inquiry - Inquiry result" page.

Submit the **"Result"** page with other necessary documents.

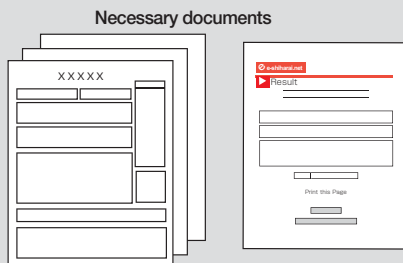

Submit for Admission Procedures

[NOTICE/FAQ]

- Please make the payment in time to complete the procedures within the payment period.
- Please complete payment by 11:00 pm Japan standard time, on the last date of the payment period.
- A transmission fee is added to Examination fee. For further information, please visit our website.
- Please note that no refund will be made under any circumstances.
- Please contact the credit card company directly if your card is not accepted.
- It is possible to use a card which carries a name different from that of the applicant. However, please make sure that all the information provided on the "Basic information" page are those of the applicant's.
- If you did not print out the "Result" page, you can check it again later on the "Application Result" page. Please enter the "Receipt Number" and "Birth Date" to redisplay the information.

For questions or problems not mentioned here, please contact :

E-Service Support Center Tel : +81-3-5952-9052 (24 hours everyday)

Admission Procedure